



181 US Hwy 46
Mine Hill, NJ 07803
(908) 654-8068
(800) 783-0567
Fax 908-654-8069

LEAD IN DRINKING WATER REPORT

Performed At:

Essex High School & Essex Campus Academy
369 Passaic Avenue, Fairfield NJ 0704

Performed For:

Essex Regional Educational Services Commission
G. Douglas Bland
333 Fairfield Road
Fairfield, NJ 07094

Prepared By:

LEW Environmental Services, LLC.
181 US Hwy 46
Mine Hill, NJ 07803

Phone (908) 654-8068

Fax (908) 654-8069

Website <http://www.LEWCorp.com>

Inspection Date: 6/4/2022

Project Number: 220435

Table of Contents

Contact Information	3
Introduction	4
Sampling Methodology	4
Drinking Water Results	5
Recommendations	5
Additional Recommendations	5

Appendices

Appendix A	Exceedances
Appendix B	Recommendations
Appendix C	All results
Appendix D	Floor Plan(S)
Appendix E	Laboratory Data

Contact Information

Agency

Client Contact:	G. Douglas Bland
Client Name:	Essex Regional Educational Services Commission
Street Address:	333 Fairfield Road Fairfield, NJ 07094
Phone Number:	(973) 902-9512

Risk Assessor(s)

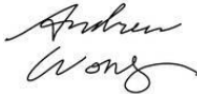
Site Assessor(s):	Andrew Wong
License:	LBP-I-1220843-1
Signature:	
Date:	June 4, 2022
E-Mail:	awong@lewcorp.com

Firm

Organization:	LEW Environmental Services, LLC.
Certification #:	NJDCA 00015 E
Street:	181 US Hwy 46
City, State & Zip:	Mine Hill, NJ 07803
Phone Number:	908-654-8068
Web Address:	http://www.lewcorp.com

Laboratory

Organization:	Environmental Hazard Services, LLC
Street:	7469 Whitepine Road
City, State & Zip:	Richmond, VA 23237
NJDEP Certification #	VA008
Phone Number:	800-347-4010

Introduction

LEW Environmental Services, LLC. was contracted by Essex Regional Educational Services Commission to test for the presence of lead in drinking water in one school in the district.

Sampling Methodology

LEW Environmental Services, LLC. followed NJAC 6A:26. Full details on sampling practices can be found in Districts Sampling Plan.

All samples were collected in 250mL wide mouth plastic containers that was prepackaged by the analytical laboratory. The sample containers may contain nitric acid, if expedited analysis is required. If not, nitric acid will be added to each sample upon arrival at the laboratory. At each sample location, the first draw sample was taken after it was determined that the water had been standing in the plumbing system for greater than eight hours but less than forty-eight hours. If second draw samples were collected, they were collecting following a flushing protocol outlined in the District's Sampling Plan.

Drinking Water Results

On June 4, 2022, LEW Environmental Services, LLC. collected the following number of water samples:

Essex High School & Academy

- 6 first draw samples collected + 1 QAQC
- 0 samples above the 15ppb action level

The complete list of samples that exceeded the 15ppb limit can be found in Appendix A. The complete list of all sample results can be found in Appendix C. The laboratory results can be found in Appendix E.

Certain outlets could not or were not tested due to various reasons. The following table lists those locations and the reason why samples were not collected.

School	Sample Location	Reason for not testing.
Essex High School & Academy	Health Suite Water Cooler	Not functional
Essex High School & Academy	Auxiliary Gym Water Cooler	Not functional

Recommendations

Those outlets where the first draw sample tested below 15ppb are not considered to be elevated and no mitigation is necessary.

For those outlets where the first draw sample exceeds 15ppb the following steps are recommended:

- 1) Immediately discontinue use of the outlets.
- 2) Conduct second draw (flush) samples on these outlets to further delineate source of contamination.

A complete list of recommendations per outlet can be found in Appendix B.

Additional Recommendations

- 1) Follow-up samples should be collected after any remediation efforts in order to determine the efficacy of the work.
- 2) Any of the inoperable/non-functioning outlets listed above that are brought back into service should be sample.
- 3) Comply with all requirements set forth in NJAC 6A:26.

Appendix A Exceedances

Appendix B Recommendations

Appendix C All Results

Sample ID	Collection Date	Collection Location	Concentration (ug/L)
EA-WC-120-R	06/04/2022	Right Water Cooler across 120	<1.00
EA-WC-120-L	06/04/2022	Left Water Cooler across 120	<1.00
EA-S-826-SF	06/04/2022	Culinary Arts Sink near Door	5.57
EA-WC-217-R	06/04/2022	Right Water Cooler across 217	<1.00
EA-WC-217-L	06/04/2022	Left Water Cooler across 217	<1.00
EA-S-218	06/04/2022	Science Room Sink	<1.00
EA-S-SR	06/04/2022	Sun Room Sink (QAQC)	<1.00

Appendix D Floor Plan(s)



1 FIRST FLOOR SCHEMATIC PLAN
 SK1.1 SCALE: 1" = 30'-0" NORTH

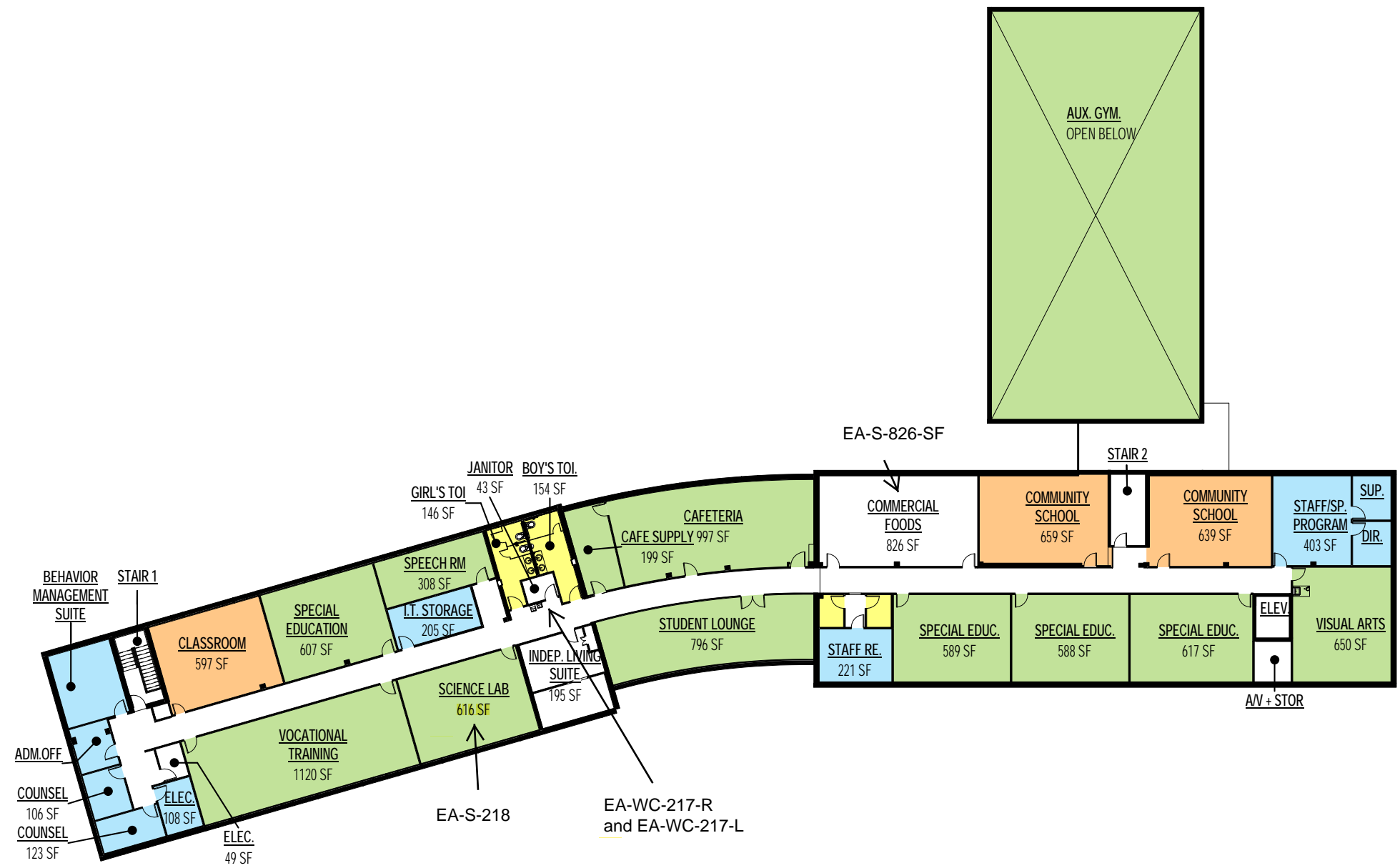

WC- Water Cooler (2)
 WF- Water Fountain (0)
 KS- Kitchen Sink (2)

2 SECOND FLOOR SCHEMATIC
 SK1.2 SCALE: 1" = 30'-0" NORTH

Appendix E Laboratory Data



Environmental Hazards Services, L.L.C.
 7469 Whitepine Rd
 Richmond, VA 23237
 Telephone: 800.347.4010

Lead in Drinking Water Analysis Report

Client: LEW Corp
 181 US Hwy 46
 Mine Hill, NJ 07803

Report Number: 22-06-00925
 Received Date: 06/06/2022
 Reported Date: 06/08/2022
 Sampled By: Andrew Wong
 Tech Certification #:

Project/Test Address: 220435; Essex Academy; 369 Passaic Avenue; Fairfield, NJ

Client Number:
 201327

Laboratory Results

Fax Number:
 Ext 18 Melissa

Lab Sample Number	Client Sample ID	Collection Date	Collection Location	Concentration ug/L (ppb)	Analysis Date	Narrative ID
22-06-00925-001	EA-WC-120-R	06/04/2022	WATER COOLER ACROSS 120 RIGHT	<1.00	06/07/2022	
22-06-00925-002	EA-WC-120-L	06/04/2022	WATER COOLER ACROSS 120 LEFT	<1.00	06/07/2022	
22-06-00925-003	EA-S-826-SF	06/04/2022	CULIANRY ARTS SINK NEAR DOOR	5.57	06/07/2022	
22-06-00925-004	EA-WC-217-R	06/04/2022	WATER COOLER ACROSS 217 RIGHT	<1.00	06/07/2022	
22-06-00925-005	EA-WC-217-L	06/04/2022	WATER COOLER ACROSS 217 LEFT	<1.00	06/07/2022	
22-06-00925-006	EA-S-218	06/04/2022	SCIENCE ROOM SINK	<1.00	06/07/2022	
22-06-00925-007	EA-S-SR	06/04/2022	SUN ROOM SINK	<1.00	06/07/2022	

Environmental Hazards Services, L.L.C

Client Number: 201327

Report Number: 22-06-00925

Project/Test Address: 220435; Essex Academy; 369 Passaic Avenue; Fairfield, NJ

Lab Sample Number	Client Sample ID	Collection Date	Collection Location	Concentration ug/L (ppb)	Analysis Date	Narrative ID
-------------------	------------------	-----------------	---------------------	--------------------------	---------------	--------------

Method: EPA 200.8

Analyst: Allison Rodriguez

Accreditation #: NJ VA008

Reviewed By Authorized Signatory: 

Melissa Kanode

QA/QC Clerk

Sample Results denoted with a "less than" (<) sign contain less than the reporting limit which is 1 ppb.

The EPA Maximum Contaminant Level for Lead in Drinking Water is 15 ppb. The results herein conform to NELAC standards, where applicable, unless otherwise narrated on this report. Results represent the analysis of samples submitted by the client. Sample location, description, field parameter results, etc., were provided by the client. This report cannot be reproduced, except in full, without written approval from Environmental Hazards Services, L.L.C.

LEGEND ug/L= micrograms per liter ppb = parts per billion



EHS Laboratories
ENVIRONMENTAL HAZARDS SERVICES, LLC

Water Chain-of-Custody Form
SHIP TO: 7469 Whitepine Rd. Richmond, VA 23237
Phone: (800) 347-4010 FAX: (804) 275-4907
ONLINE CLIENT PORTAL AVAILABLE FOR ANALYSIS RESULTS AT: www.leadlab.com

22-06-00925



Due Date:
06/13/2022
(Monday)
AE

PK

Company Name: LEW CORP

Account #: 201327

Address: 181 US Highway 46

City/State/Zip: Mine Hill, NJ 07803

Phone: 908-654-8068

Email: labresults@lewcorp.com

Fax: 908-654-8069

Project Name / Collection Address: (Required)

ESSEX ACADEMY
369 PASSAIC AVE

City/State/Zip: (Required)

FAIRFIELD, NJ

Project #: 220435

Sampled By: ANDREW BLONIG

License # (If Required):

Water Source: (Check One) Public Well

Well Tag # (If Applicable):

X 5 Day Turnaround 3 Day Turnaround 2 Day Turnaround 1 Day Turnaround * Call Ahead

No.	Client Sample ID	Collection Location (Ex: Kitchen Sink)	Collection Date	Collection Time	Metals			Field Parameters			LAB USE
					Lead	Copper	Other	Field pH at time of Collection:	Temp. at time of Collection:	Temp at Time of Receipt:	
1	EA-WC-120R	WATER ACROSS 120 (RIGHT) COOLER	6/4/22	8 AM	✓						
2	-WC-120-L	↓ ↓ ↓ (LEFT)									
3	-S-826SF	CULINARY ARTS SINK (NEAR)									
4	-WC-217-R	WATER ACROSS 217 (RIGHT) COOLER									
5	↓ ↓ ↓ -L	↓ ↓ ↓ (LEFT)									
6	-S-218	SCIENCE ROOM SINK									
7	↓ -S-512	SUN ROOM SINK									
8											
9											
10											

7
AK

Released by: ANDREW BLONIG
Signature: [Signature]
Date/Time: 6/4/22 5 PM

Released by: STEPHAN BOLE
Signature: [Signature]
Date/Time: 6/10/22 12:04 PM